



Electrical Information			
Model No	SL10-40	SL10-50	SL10-60
Power Consumption(η15%)	40W	50W	60W
Battery	LiFePO4 battery		
Battery Capacity	307.2Wh-24Ah	384Wh-30Ah	460.8Wh-36Ah
Solar Panels	Mono-crystalline solar panel		
Solar Panel Wattage	60W		
Charging Time	>6Hrs	>7Hrs	>9Hrs
Operating time	Normal mode with 100% brightness>8hours, Intelligent mode 3-4 days		
Solar Charge Controller	MPPT		
Working mode	Refer Intelligent control		
Control	Timmer dimming/PIR sensor		

Optic Information			
LED Type	LED 2835		
Luminous Flux (η10%)	8000lm	10000lm	12000lm
Efficacy(4000K Ra70)	200lm/W		
Correlated Color Temperature	4000K (3000K, 5000K optional)		
Color Rendering Index	Ra70 (Ra80 optional)		
Beam Angle	R10801, R10803, R10805		
UGR Level	NA		

Description

SL10 Solar Fin is a new design solar LED street light, with slim design and higher conversation efficiency mono-crystalline photovoltaic solar panel, 200lm/w efficiency to makes the products with better advantages to meet different requirements from customers.

Key Features

- Nice design with lighter weight, easier installation
- System efficiency up to 200lm/w with competitive price
- The controller has built in PIR sensor and timer dimming function
- LiFePO4 battery is with longer lifetime, charge for 8 hours which can continuous working for 3 days
- IP65 protection
- Mono-crystalline photovoltaic with a higher conversation efficiency
- Adjustable angle
- Different mounting options

Dimentions and Mount			
Product Dimension (Side Entry)	965x429x187mm		
Luminaire Net Weight	13.9±0.3kg	14.4±0.3kg	15±0.3kg
Export Carton Size	1020x520x255mm		
Gross Weight	15.7±0.3kg	16.2±0.3kg	16.8±0.3kg
Mounting Option	Post top mount		
	Side entry mount		
Material	Aluminum alloy		
	Polycarbonate optical lens		
	Lifepo4 battery		
	Mono-crystalline solar panel		
Finish	Powder coating		
Fixture Color	Silver		
EPA	4.95ft²/0.46m²		
IP Rating	IP65		
Category of corrosion	C3		

Lifespan and Warranty	
Operating Temperature	0°C to + 50°C
Life Time of LED @Ta=25°C	31000hrs-L90
	64000hrs-L80
	101000hrs-L70
Warranty	Battery 3 Years
	Other accessories 5 Years

Applications

- Village streets
- Urban road
- Courtyard
- Parking lot

New Features	
<p><i>* Please consult us for details.</i></p>	

Photometry

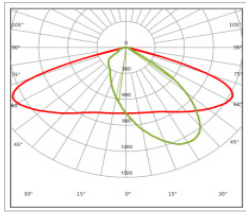

R10801

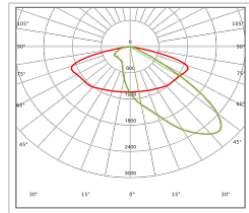

R10803

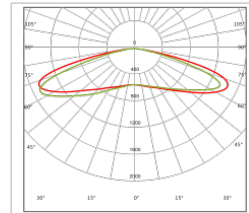

R10805

Mounting Options



Side Entry Mount



Post Top Mount

Intelligent Control Mode

5 Stage Night Mode

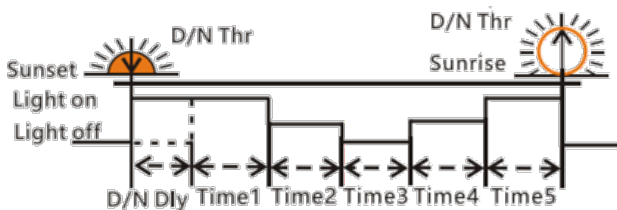

*You can note the Sensor function is only available at Time 3 and Time 4

*Please note the fixtures with 5 stages timer dimming yourself by the remote controller.

Factory Default setting



With sufficient natural light, the light keeps charging.

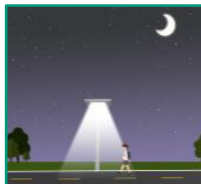

The light keeps 100% brightness for 0.5 hour.

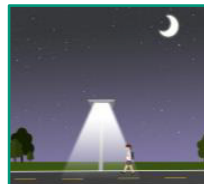

The light keeps 50% brightness when presence is detected in the 1st 4 hours.

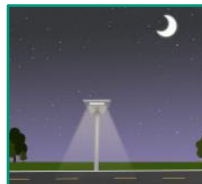

The light keeps 10% brightness when no presence is detected after 30S hold time in the 1st 4 hours.

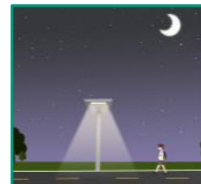

The light keeps 20% brightness when presence is detected in the 2nd 4 hours.

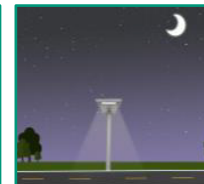

The light keeps 10% brightness when no presence is detected after 30S hold time in the 2nd 4 hours.

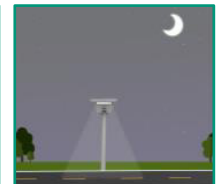

The light keeps 10% brightness for 3 hours until sunrise.

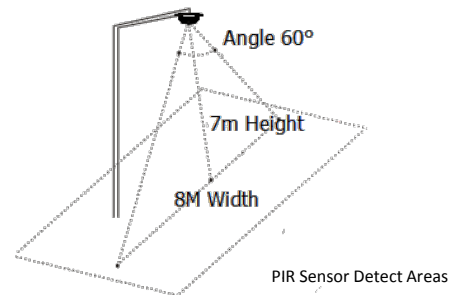

Dimensions

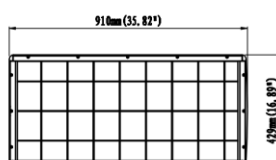
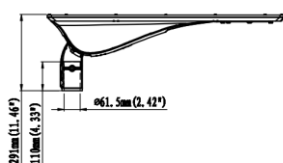

Post Top Mount

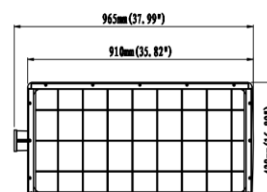
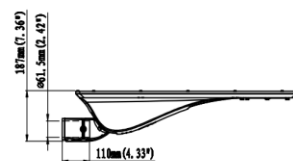

Side Entry Mount

Accessories



Optic lens

High transmittance PC materials,
UV test approval.

Code: please refer to Photometry for different
beam angle.

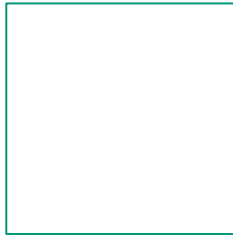

Pole mount spigot

ADC12 materials, $\pm 15^\circ$ tilt adjustable, for dia.
60/ 76mm pole.



Remote Controller

Remote Controller for Solar Street light.



Wall mount adaptor

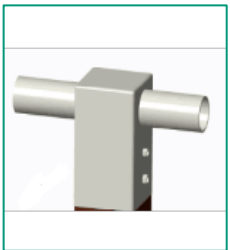

T shape pole mount adaptor



T shape pole mount adaptor



L shape pole mount adaptor



L shape pole mount adaptor

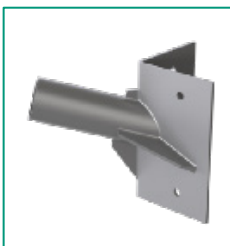

Corner mount adaptor



L shape pole mount adaptor